

Marlow Court, Crowborough, TN6 1NW



£169,950

Peter Oliver
01825 703000



▼ Stunning Flat

▼ Top Floor, Purpose Built

▼ Residents Parking

▼ One Bedroom

▼ Feature Open Plan Living

▼ No Chain

DESCRIPTION

This one bedroom top floor flat is beautifully presented throughout and comes with a recently renewed lease. Situated in a convenient location which is a stone's throw away from a local shop with Crowborough's town centre just a short trip away. You are also on the right side of town for access to the Ashdown Forest or the Crowborough Beacon Golf Course for some lovely countryside walks! Now the flat itself is on the top floor and is modern throughout. The main lounge/dining/kitchen area is a perfect space for entertaining and plenty of space for a one bedroom apartment. The bedroom is a good size double so overall this is a generous size. There is a car park out the back which provides parking for the flat and with all things considered, this apartment will tick most if not all of your boxes. We feel this will be ideal for a first time purchase or an investment buyer looking to rent the property out.



Peter Oliver

ACCOMMODATION/FLOORPLAN

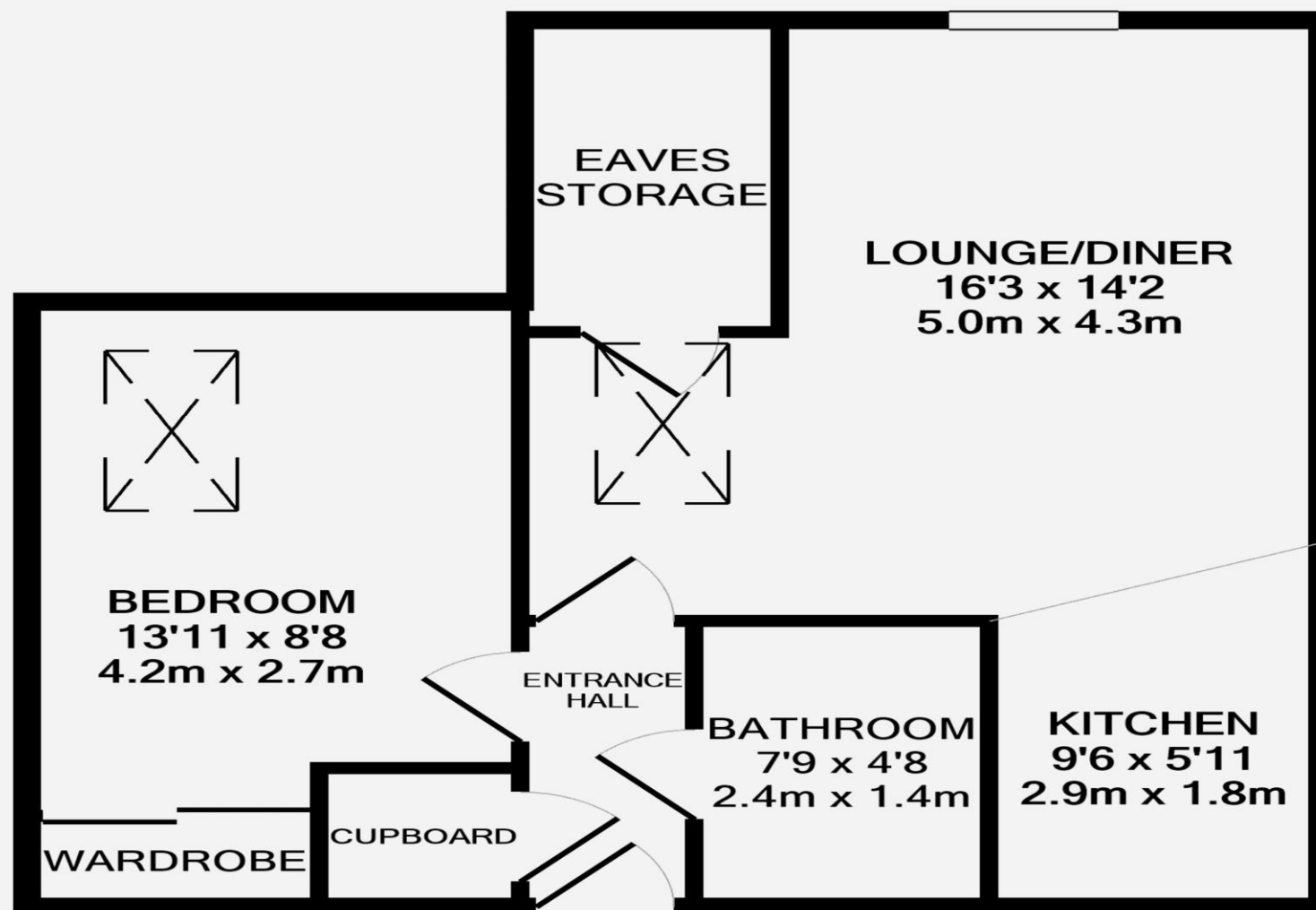

TOTAL APPROX. FLOOR AREA 483 SQ.FT. (44.8 SQ.M.)

Whilst every attempt has been made to ensure the accuracy of the floor plan contained here, measurements of doors, windows, rooms and any other items are approximate and no responsibility is taken for any error, omission, or mis-statement. This plan is for illustrative purposes only and should be used as such by any prospective purchaser. The services, systems and appliances shown have not been tested and no guarantee as to their operability or efficiency can be given
Made with Metropix ©2021



Score	Energy rating	Current	Potential
92+	A		
81-91	B		
69-80	C	80 c	80 c
55-68	D		
39-54	E		
21-38	F		
1-20	G		

